

## KSQB-1WC 垫片规格及公差 KSQB-1WC Thrust Washer Specification & Tolerance

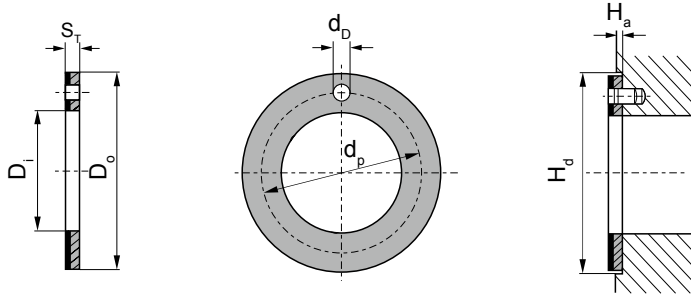

单位Unit: mm

轴径 Shaft D <sub>s</sub>	型号规格 Standard No.	垫片尺寸 Washer size				安装尺寸 Assemble size		H <sub>a</sub> +0.12	
		D <sub>i</sub> +0.25	D <sub>o</sub> -0.25	S <sub>r</sub> -0.05	d <sub>p</sub> ±0.125	d <sub>o</sub> +0.4 +0.1	H <sub>a</sub> ±0.2		
8	W10	10	20	1.5	15	1.5	1	20	
10	W12	12	24		18			2	32
12	W14	14	26		20				
14	W16	16	30		23			4	54
16	W18	18	32		25	1.5			
18	W20	20	36		28			78	
20	W22	22	38		30	90			
22	W24	24	42		33			90	
24	W26	26	44		35	90			
26	W28	28	48		38		90		
30	W32	32	54		43	90			
36	W38	38	62		50		90		
40	W42	42	66		54	90			
46	W48	48	74		61		90		
50	W52	52	78	65	90				
60	W62	62	90	76		90			

## KSQB-1SP 板材规格及公差 KSQB-1SP Strip Specification & Tolerance

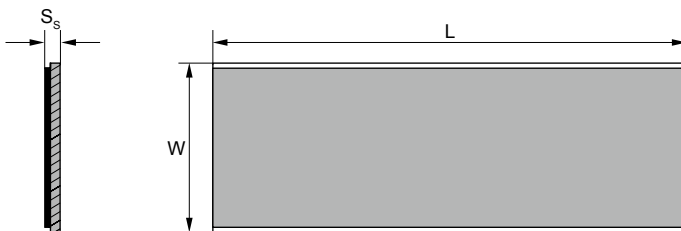

单位Unit: mm

型号规格 Standard No.	长度 L±1	宽度 W±1	厚壁 Wall thickness S <sub>s</sub> -0.05
SP	500	150	1.0
SP	500	150	1.5
SP	500	150	2.0
SP	500	150	2.5